

連座軸承系列

BEARINGS



SINGLE ROW TRANSMISSION BEARING UNITS

BEARINGS

BEARINGS

ピロー形ユニット

UCP 200

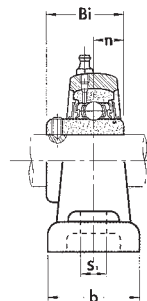
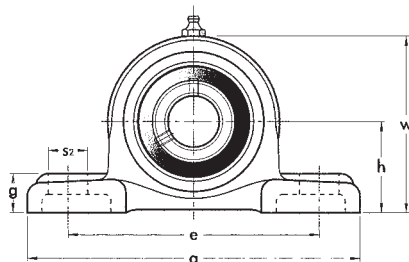

TRL type Seal



SR type Seal

Unit.No	Shaft.Dia		Dimensions (mm)										Bolt Size	Load Rating (kgs)		Weight (Kgs)
	(mm)	in	h	a	e	b	s ₁	s ₂	g	w	Bi	n		Dynamic	Static	
UCP 201	12	1/2	30.2	127	95	38	13	19	15	62	31	12.7	M10	1010	630	0.65
UCP 202	15	9/16, 5/8	30.2	127	95	38	13	19	15	62	31	12.7	M10	1010	630	0.63
UCP 203	17	11/16	30.2	127	95	38	13	19	15	62	31	12.7	M10	1010	630	0.62
UCP 204	20	3/4	33.3	127	95	38	13	19	15	64	31	12.7	M10	1010	630	0.65
UCP 205	25	7/8, 1	36.5	140	105	38	13	19	16	71	34	14.3	M10	1100	710	0.79
UCP 206	30	1 1/8, 1 3/16	42.9	165	121	48	17	21	18	84	38.1	15.9	M14	1540	1020	1.3
UCP 207	35	1 1/4, 1 3/8	47.6	167	127	48	17	21	19	94	42.9	17.5	M14	2030	1400	1.6
UCP 208	40	1 1/2, 1 9/16	49.2	184	137	54	17	21	19	100	49.2	19	M14	2300	1600	2
UCP 209	45	1 5/8, 1 3/4	54	190	146	54	17	23	20	108	49.2	19	M14	2570	1810	2.3
UCP 210	50	1 7/8, 1 15/16	57.2	206	159	60	20	24	20	114	51.6	19	M16	2760	2010	2.7
UCP 211	55	2, 2 1/8	63.5	219	171	60	20	25	22	126	55.6	22.2	M16	3400	2550	3.3
UCP 212	60	2 1/4, 2 3/8	69.8	241	184	70	20	25	25	138	65.1	25.4	M16	4100	3150	4.7
UCP 213	65	2 1/2	76.2	265	203	70	25	29	27	150	65.1	25.4	M20	4500	3500	5.6
UCP 214	70	2 3/4	79.4	266	210	72	25	30	28	156	74.6	30.2	M20	4900	3800	7.3
UCP 215	75	2 5/8, 3	82.6	275	217	74	25	30	28	162	77.8	33.3	M20	5200	4200	7.9

BEARINGS

角フランジ形ユニット

UCF 200

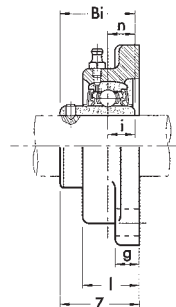
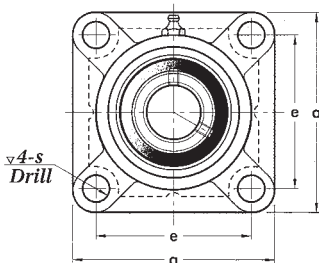

TRL type Seal



SR type Seal

Unit.No	Shaft.Dia		Dimensions (mm)										Bolt Size	Load Rating (kgs)		Weight (kgs)
	(mm)	in	a	e	i	g	l	s	Z	Bi	n	Dynamic		Static		
UCF 201	12	1/2	86	64	15	12	25.5	12	33.3	31	12.7	M10	1010	630	0.64	
UCF 202	15	9/16, 5/8	86	64	15	12	25.5	12	33.3	31	12.7	M10	1010	630	0.62	
UCF 203	17	11/16	86	64	15	12	25.5	12	33.3	31	12.7	M10	1010	630	0.61	
UCF 204	20	3/4	86	64	15	12	25.5	12	33.3	31	12.7	M10	1010	630	0.59	
UCF 205	25	7/8, 1	95	70	16	14	27	12	35.7	34	14.3	M10	1100	710	0.82	
UCF 206	30	1 1/8, 1 3/16	108	83	18	14	31	12	40.2	38.1	15.9	M10	1540	1020	1.1	
UCF 207	35	1 1/4, 1 3/8	117	92	19	16	34	14	44.4	42.9	17.5	M12	2030	1400	1.5	
UCF 208	40	1 1/2, 1 9/16	130	102	21	16	36	16	51.2	49.2	19	M14	2300	1600	2	
UCF 209	45	1 5/8, 1 3/4	137	105	22	18	38	16	52.2	49.2	19	M14	2570	1810	2.4	
UCF 210	50	1 7/8, 1 15/16	143	111	22	18	40	16	54.6	51.6	19	M14	2760	2010	2.5	
UCF 211	55	2, 2 1/8	162	130	25	20	43	19	58.4	55.6	22.2	M16	3400	2550	3.4	
UCF 212	60	2 1/4, 2 3/8	175	143	29	20	48	19	68.7	65.1	25.4	M16	4100	3150	4.6	
UCF 213	65	2 1/2	187	149	30	20	50	19	69.7	65.1	25.4	M16	4500	3500	5.5	
UCF 214	70	2 3/4	193	152	31	22	54	19	75.4	74.6	30.2	M16	4900	3800	6.1	
UCF 215	75	2 5/8, 3	200	159	34	22	56	19	78.5	77.8	33.3	M16	5200	4200	6.9	

BEARINGS

BEARINGS

ひしフランジ形ユニット
UCFL 200

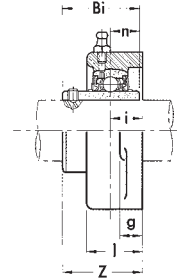
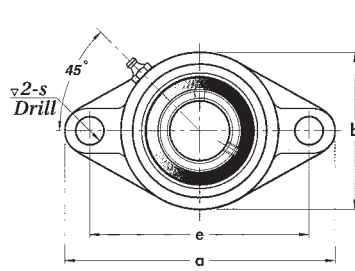

Unit.No	Shaft.Dia		Dimensions (mm)										Bolt Size	Load Rating (kgs)		Weight (kgs)
	(mm)	in	a	e	i	g	l	s	b	z	Bi	n		Dynamic	Static	
UCFL 201	12	1/2	113	90	15	12	25.5	12	60	33.3	31	12.7	M10	1010	630	0.5
UCFL 202	15	9/16, 5/8	113	90	15	12	25.5	12	60	33.3	31	12.7	M10	1010	630	0.48
UCFL 203	17	11/16	113	90	15	12	25.5	12	60	33.3	31	12.7	M10	1010	630	0.47
UCFL 204	20	3/4	113	90	15	12	25.5	12	60	33.3	31	12.7	M10	1010	630	0.45
UCFL 205	25	7/8, 1	130	99	16	14	27	16	68	35.7	34	14.3	M14	1100	710	0.63
UCFL 206	30	1 1/8, 1 3/16	148	117	18	14	31	16	80	40.2	38.1	15.9	M14	1540	1020	0.93
UCFL 207	35	1 1/4, 1 3/8	161	130	19	16	34	16	90	44.4	42.9	17.5	M14	2030	1400	1.2
UCFL 208	40	1 1/2, 1 9/16	175	144	21	16	36	16	100	51.2	49.2	19	M14	2300	1600	1.6
UCFL 209	45	1 5/8, 1 3/4	188	148	22	18	38	19	108	52.2	49.2	19	M16	2570	1810	1.9
UCFL 210	50	1 7/8, 1 15/16	197	157	22	18	40	19	115	54.6	51.6	19	M16	2760	2010	2.2
UCFL 211	55	2, 2 1/8	224	184	25	20	43	19	130	58.4	55.6	22.2	M16	3400	2550	3.2
UCFL 212	60	2 1/4, 2 3/8	250	202	29	20	48	23	140	68.7	65.1	25.4	M20	4100	3150	4.1
UCFL 213	65	2 1/2	258	210	30	20	50	23	155	69.7	65.1	25.4	M20	4500	3500	5.1
UCFL 214	70	2 3/4	265	216	31	20	54	23	160	75.4	74.6	30.2	M20	4900	3800	6
UCFL 215	75	2 15/16, 3	275	225	34	20	56	23	165	78.5	77.8	33.3	M20	5200	4200	6.5

BEARINGS

テークアップ形ユニット
UCT 200

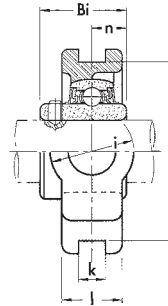
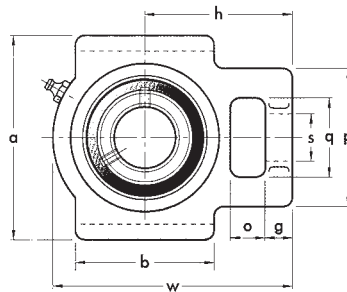

Unit.No	Shaft.Dia		Dimensions (mm)													Load Rating (kgs)		Weight (kgs)		
	(mm)	in	o	g	p	q	s	b	k	e	a	w	i	l	h	Bi	n		Dynamic	Static
UCT 201	12	1/2	16	10	51	32	19	51	12	76	89	94	32	21	62	31	12.7	1010	630	0.79
UCT 202	15	9/16, 5/8	16	10	51	32	19	51	12	76	89	94	32	21	62	31	12.7	1010	630	0.77
UCT 203	17	11/16	16	10	51	32	19	51	12	76	89	94	32	21	62	31	12.7	1010	630	0.76
UCT 204	20	3/4	16	10	51	32	19	51	12	76	89	94	32	21	62	31	12.7	1010	630	0.74
UCT 205	25	7/8, 1	16	10	51	32	19	51	12	76	89	97	32	24	62	34	14.3	1100	710	0.82
UCT 206	30	1 1/8, 1 3/16	16	10	56	37	22	57	12	89	102	113	37	28	70	38.1	15.9	1540	1020	1.3
UCT 207	35	1 1/4, 1 3/8	16	13	64	37	22	64	12	89	102	129	37	30	78	42.9	17.5	2030	1400	1.6
UCT 208	40	1 1/2, 1 9/16	19	16	83	49	29	83	16	102	114	144	49	33	88	49.2	19	2300	1600	2.4
UCT 209	45	1 5/8, 1 3/4	19	16	83	49	29	83	16	102	117	144	49	35	87	49.2	19	2570	1810	2.4
UCT 210	50	1 7/8, 1 15/16	19	16	83	49	29	86	16	102	117	149	49	37	90	51.6	19	2760	2010	2.5
UCT 211	55	2, 2 1/8	25	19	102	64	35	95	22	130	146	171	64	38	106	55.6	22.2	3400	2550	4
UCT 212	60	2 1/4, 2 3/8	32	19	102	64	35	102	22	130	146	194	64	42	119	65.1	25.4	4100	3150	5.1
UCT 213	65	2 1/2	32	21	111	70	41	121	26	151	167	224	70	44	137	65.1	25.4	4500	3500	7
UCT 214	70	2 3/4	32	21	111	70	41	121	26	151	167	224	70	46	137	74.6	30.2	4900	3800	7.1
UCT 215	75	2 15/16, 3	32	21	111	70	41	121	26	151	167	232	70	48	140	77.8	33.3	5200	4200	7.5

BEARINGS

印ろう付丸フランジ形ユニット
UCFC 200

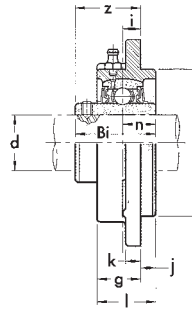
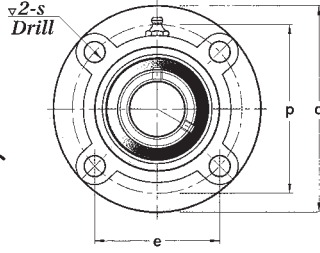

Unit.No	Shaft.Dia		Dimensions (mm)													Bolt Size	Load Rating (kgs)		Weight (kgs)
	(mm)	in	a	p	e	i	l	s	j	k	g	f	z	Bi	n		Dynamic	Static	
UCFC 201	12	1/2	100	78	55.1	10	25.5	12	5	7	20.5	62	28.3	31	12.7	M10	1010	630	0.78
UCFC 202	15	9/16, 5/8	100	78	55.1	10	25.5	12	5	7	20.5	62	28.3	31	12.7	M10	1010	630	0.78
UCFC 203	17	11/16	100	78	55.1	10	25.5	12	5	7	20.5	62	28.3	31	12.7	M10	1010	630	0.78
UCFC 204	20	3/4	100	78	55.1	10	25.5	12	5	7	20.5	62	28.3	31	12.7	M10	1010	630	0.78
UCFC 205	25	7/8, 1	115	199	63.6	10	27	12	6	7	21	70	29.7	34	14.3	M10	1100	710	0.95
UCFC 206	30	1 1/8, 1 3/16	125	100	70.7	10	31	12	8	8	23	80	32.2	38.1	15.9	M10	1540	1020	1.4
UCFC 207	35	1 1/4, 1 3/8	135	110	77.8	11	34	14	8	9	26	90	36.4	42.9	17.5	M12	2030	1400	1.7
UCFC 208	40	1 1/2, 1 9/16	145	120	84.8	11	36	14	10	9	26	100	41.2	49.2	19	M12	2300	1600	2
UCFC 209	45	1 5/8, 1 3/4	160	132	93.3	10	38	16	12	14	26	105	40.2	49.2	19	M14	2570	1810	2.8
UCFC 210	50	1 7/8, 1 15/16	165	138	97.6	10	40	16	12	14	28	110	42.6	51.6	19	M14	2760	2010	3
UCFC 211	55	2, 2 1/8	185	150	106.1	13	43	19	12	15	31	125	46.4	55.6	22.2	M16	3400	2550	4
UCFC 212	60	2 1/4, 2 3/8	195	160	113.0	17	48	19	12	15	36	135	56.7	65.1	25.4	M16	4100	3150	4.7
UCFC 213	65	2 1/2	205	170	120.2	16	50	19	14	15	36	145	55.7	65.1	25.4	M16	4500	3500	5.4
UCFC 214	70	2 3/4	215	177	125.1	17	54	19	14	18	40	150	61.4	74.6	30.2	M16	4900	3800	6.8

BEARINGS

ピロー形ユニット
UCPA 200

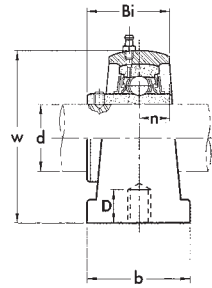
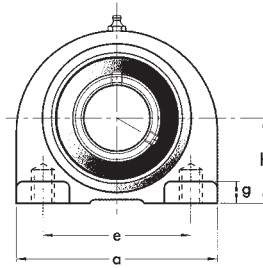

Unit.No	Shaft.Dia		Dimensions (mm)										Bolt Size	Load Rating (kgs)		Weight (kgs)
	(mm)	in	h	a	e	b	s	g	w	D	Bi	n		Dynamic	Static	
UCPA 201	12	1/2	30.2	76	52	40	10	11	62	15	31	12.7	M10	1010	630	0.64
UCPA 202	15	9/16, 5/8	30.2	76	52	40	10	11	62	15	31	12.7	M10	1010	630	0.64
UCPA 203	17	11/16	30.2	76	52	40	10	11	62	15	31	12.7	M10	1010	630	0.64
UCPA 204	20	3/4	30.2	76	52	40	10	11	62	15	31	12.7	M10	1010	630	0.64
UCPA 205	25	7/8, 1	36.5	84	56	45	10	12	72	15	34	14.3	M10	1100	710	0.83
UCPA 206	30	1 1/8, 1 3/16	42.9	94	66	50	14	12	84	18	38.1	15.9	M14	1540	1020	1.2
UCPA 207	35	1 1/4, 1 3/8	47.6	110	80	55	14	13	95	20	42.9	17.5	M14	2030	1400	1.7
UCPA 208	40	1 1/2, 1 9/16	49.2	116	84	58	14	13	100	20	49.2	19	M14	2300	1600	2.0
UCPA 209	45	1 5/8, 1 3/4	54.2	120	90	60	14	13	108	25	49.2	19	M14	2570	1810	2.2
UCPA 210	50	1 7/8, 1 15/16	57.2	130	94	64	16	14	116	25	51.6	19	M16	2760	2010	2.8

BEARINGS

ピロー形ユニット
UCPH 200

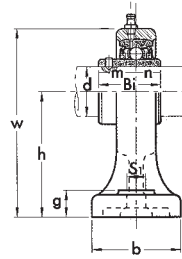
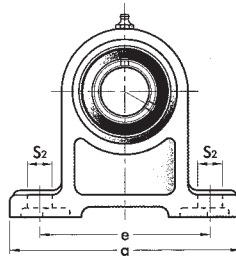

Unit.No	Shaft.Dia		Dimensions (mm)										Bolt Size	Load Rating (kgs)		Weight (kgs)
	(mm)	in	h	a	e	b	S ₁	S ₂	g	w	Bi	n		Dynamic	Static	
UCPH 201	12	1/2	70	127	95	40	13	19	15	101	31	12.7	M10	1010	630	0.96
UCPH 202	15	9/16, 5/8	70	127	95	40	13	19	15	101	31	12.7	M10	1010	630	0.96
UCPH 203	17	11/16	70	127	95	40	13	19	15	101	31	12.7	M10	1010	630	0.96
UCPH 204	20	3/4	70	127	95	40	13	19	15	101	31	12.7	M10	1010	630	0.96
UCPH 205	25	7/8, 1	80	140	105	50	13	19	16	114	34	14.3	M10	1100	710	1.2
UCPH 206	30	1 1/8, 1 3/16	90	165	121	50	17	21	18	130	38.1	15.9	M14	1540	1020	1.6
UCPH 207	35	1 1/4, 1 3/8	95	167	127	60	17	21	28	140	42.9	17.5	M14	2030	1400	2

Load Rating Data

Bearing load ratings at various r.p.m. based on 500 hours minimum life 2,500 hours average life.

UC	Bearing No.			R.P.M.											
	SA.CSA	SB.CSB	UCX	50	100	250	500	750	1000	1500	2000	2400	3600	5000	
	201~3	201~3		1460	1150	840	670	580	530	470	430	400	340	310	
				665	520	380	305	265	240	215	195	180	155	140	
201~4	204	204		1950	1540	1140	900	780	710	630	570	530	460	420	
				885	700	520	410	355	325	285	260	240	210	190	
205	205	205		2120	1670	1240	980	850	720	680	620	580	510	450	
				965	760	565	445	385	325	310	280	265	230	205	
206	206	206	X05	2950	2330	1730	1370	1200	1080	950	860	810	700	630	
				1340	1060	785	625	545	490	430	390	370	320	285	
207	207	207	X06	3880	3060	2290	1790	1580	1420	1250	1130	1070	930		
				1765	1390	1040	815	720	645	570	515	485	425		
208	208	208	X07	4400	3470	2590	2030	1790	1610	1410	1280	1220	1060		
				2000	1580	1180	930	815	730	640	580	555	480		
209	209		X08	4960	3910	2890	2290	2001	1810	1590	1440	1350			
				2250	1780	1315	1040	915	825	725	655	615			
210	210		X09	5310	4180	3110	2460	2150	1940	1700	1550	1470			
				2415	1900	1415	1120	975	880	770	705	670			
211	211		X10	6560	5170	3830	3040	2650	2400	2110	1910	1800			
				2980	2350	1740	1380	1205	1090	960	870	820			
212			X11	7900	6270	4620	3670	3200	2900	2540	2300	2170			
				3590	2850	2100	1670	1455	1320	1155	1045	985			
213			X12	8670	6880	5070	4020	3510	3190	2790	2530				
				3940	3125	2305	1825	1595	1450	1270	1150				
214			X13	9940	7490	5520	4380	3820	3470	3040	2760				
				4520	3405	2510	1990	1735	1575	1380	1225				
215			X14	10210	8100	5850	4740	4060	3690	3290	2930				
				4640	3680	2660	2155	1845	1675	1495	1330				
216			X15	10980	8710	6420	5090	4450	4040	3530					
				4990	3960	2920	2315	2020	1835	1605					

UP 000

PILLOW BLOCKS

*Open and closed stainless covers available.

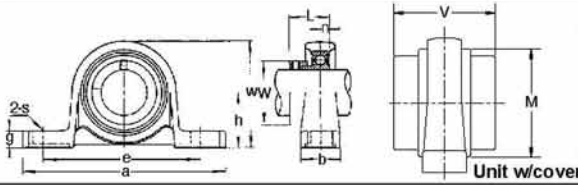

- Extra Narrow Inner Ring
- ZDC Alloy with electroless chromate finish
- High carbon chromium bearing steel

Shaft Diam. (mm)	AMI Unit #	List Price	List Price w/cover (C)/(CE)	Dimensions (mm)												Bolt Size (mm)	Bearing #	Housing #	Weight (lb.)
				h	a	e	b	s	g	w	L	n	W	v	M				
10	UP 000	41.50	45.65	18	67	53	16	7	6	35	17.5	4	17	33	29	M6	U 000	P 000	0.17
12	UP 001	42.50	46.65	19	71	56	16	7	6	38	17.5	4	19	33	31	M6	U 001	P 001	0.20
15	UP 002	45.30	49.45	22	80	63	16	7	7	43	18.5	4.5	22	34	35	M6	U 002	P 002	0.28
17	UP 003	48.80	53.05	24	85	67	18	7	7	47	20.5	5	25	38	38	M6	U 003	P 003	0.35
20	UP 004	51.80	56.05	28	100	80	20	10	9	55	24.5	6	30	46	45	M8	U 004	P 04-5	0.52
25	UP 005	59.40	63.65	32	112	90	20	10	10	62	25.5	6	36	47	50	M8	U 005	P 05-6	0.66
30	UP 006	72.20	78.20	36	132	106	26	13	11	70	26.5	6.5	42	50	58	M10	U 006	P 06-7	1.01

UFL 000

TWO-BOLT FLANGE UNITS

*Open and closed stainless covers available.

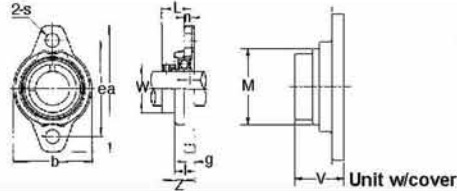

- Extra Narrow Inner Ring
- ZDC Alloy with electroless chromate finish
- High carbon chromium bearing steel

Shaft Diam. (mm)	AMI Unit #	List Price	List Price w/cover (C)/(CE)	Dimensions (mm)												Bolt Size (mm)	Bearing #	Housing #	Weight (lb.)	
				a	e	i	g	l	s	b	Z	L	n	W	v					M
10	UFL 000	41.50	45.65	60	45	5.5	5.5	11.5	7	36	19	17.5	4	17	22	29	M6	U 000	FL 000	0.14
12	UFL 001	42.50	46.65	63	48	5.5	5.5	11.5	7	38	19	17.5	4	19	22	31	M6	U 001	FL 001	0.17
15	UFL 002	45.30	49.45	67	53	6.5	6.5	13	7	42	20.5	18.5	4.5	22	24	35	M6	U 002	FL 002	0.22
17	UFL 003	48.80	53.05	71	56	7	7	14	7	46	22.5	20.5	5	25	26	38	M6	U 003	FL 003	0.29
20	UFL 004	51.80	56.05	90	71	8	8	16	10	55	26.5	24.5	6	30	31	45	M8	U 004	FL 04-5	0.46
25	UFL 005	59.40	63.65	95	75	8	8	16	10	60	27.5	25.5	6	36	32	50	M8	U 005	FL 05-6	0.54
30	UFL 006	72.20	78.20	112	85	9	9	18	13	70	29	26.5	6.5	42	34	58	M10	U 006	FL 06-7	0.79
35	UFL 007	83.85	90.10	122	95	10	10	20	13	80	32.5	29.5	7	48	—	—	M10	U 007	FL 07-8	1.10

U/URE 000

BALL BEARINGS

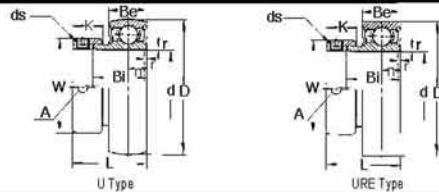

- Extra Narrow Inner Ring
- 0°F ~ 212°F
- Contact Seal
- High carbon chromium bearing steel

Shaft Diam. (mm)	AMI Unit #	List Price	Dimensions (mm)										Basic Load Rating (kgf.)		Weight (lb.)
			D	L	Bi	Be	r	n	k	W	A	ds	Dynamic Cr	Static Cor	
10	U 000	27.10	26	17.5	11	8	0.5	4	8.5	17	3.5	M4X0.7	470	200	0.07
12	U 001	28.50	28	17.5	11	8	0.5	4	8.5	19	3.5	M4X0.7	520	245	0.08
15	U 002	29.60	32	18.5	12	9	0.5	4.5	8.5	22	3.5	M4X0.7	570	290	0.11
17	U 003	34.40	35	20.5	13.5	10	0.5	5	9.5	25	3.5	M4X0.7	610	335	0.14
20	U 004	37.90	42	24.5	16.5	12	1	6	11	30	5	M5X0.8	955	515	0.23
25	U 005	44.40	47	25.5	17.5	12	1	6	12	36	5	M5X0.8	1030	595	0.30
30	U 006	52.70	55	26.5	18.5	13	1.5	6.5	12	42	5	M5X0.8	1350	845	0.42
35	U 007	56.20	62	29.5	20	14	1.5	7	13.5	48	5	M6X0.75	1625	1050	0.56
20	URE 004	37.90	42	24.5	16.5	12	1	6	11	30	5	M5X08	955	515	0.23
3/4	URE 004-12														

*URE designates cylindrical O.D.